

Singapore Samples

Density can take diverse forms. Asst Prof **Erik G. L'Heureux** and his students at the Department of Architecture, School of Design and Environment, National University of Singapore, developed this set of five axonometric drawings comparing one-square-kilometre plots of five different neighbourhoods in Singapore. These range from high-rise public housing in the Jurong West township to the spacious houses of the Bukit Timah suburb. In the Central Business District and Little India, modern high-rises stand alongside low-rise conserved buildings. Depending on a society's values, a dense city can still preserve its heritage or provide varied housing options for its people.

CBD

Population

238,442

Total Open Space

594,036 m² – 59%

Footprint of Building

405,964 m² – 41%

Total Floor Area

3,576,632 m² – 358%

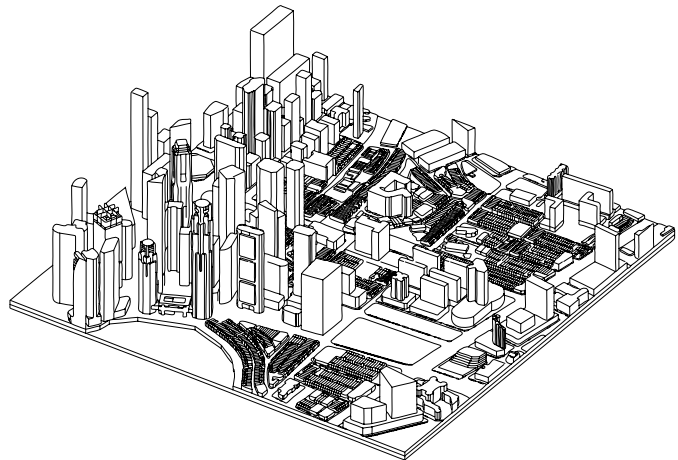

Jurong West

Population

52,100

Total Open Space

741,842 m² – 74%

Footprint of Building

258,158 m² – 26%

Total Floor Area

3,815,780 m² – 380%

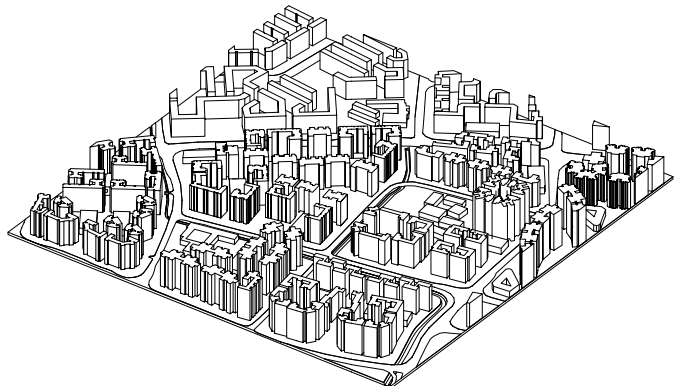

Tuas Industrial Estate

Population

3,840

Total Open Space

6,798,550 m² – 70%

Footprint of Building

300,145 m² – 30%

Total Floor Area

450,000 m² – 45%

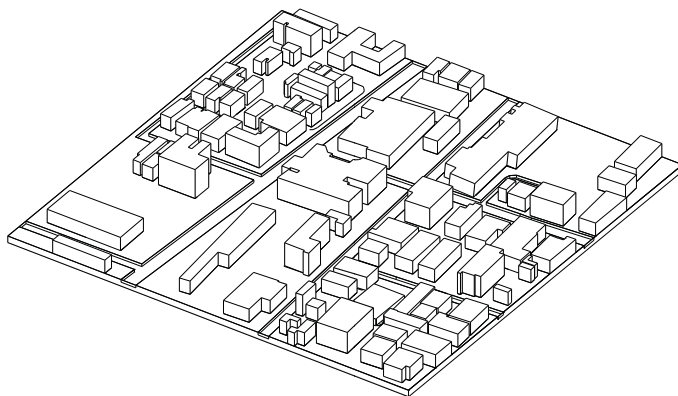

Little India

Population

11,595

Total Open Space

857,573 m² – 86%

Footprint of Building

142,427 m² – 14%

Total Floor Area

647,438 m² – 65%

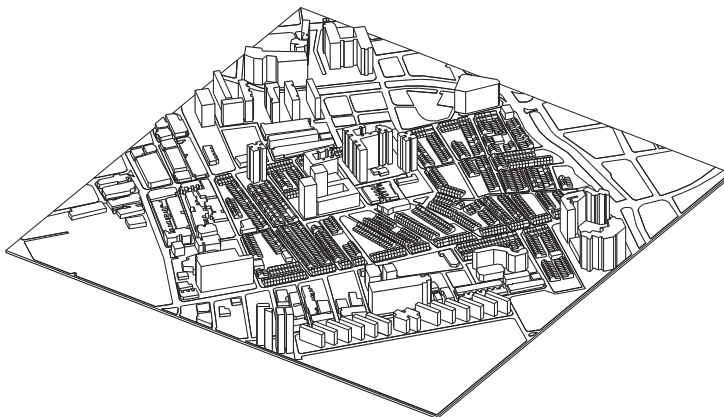

Bukit Timah Road

Population

4,620

Total Open Space

774,264 m² – 77%

Footprint of Building

225,736 m² – 23%

Total Floor Area

564,340 m² – 56%

